

CAR PARKING

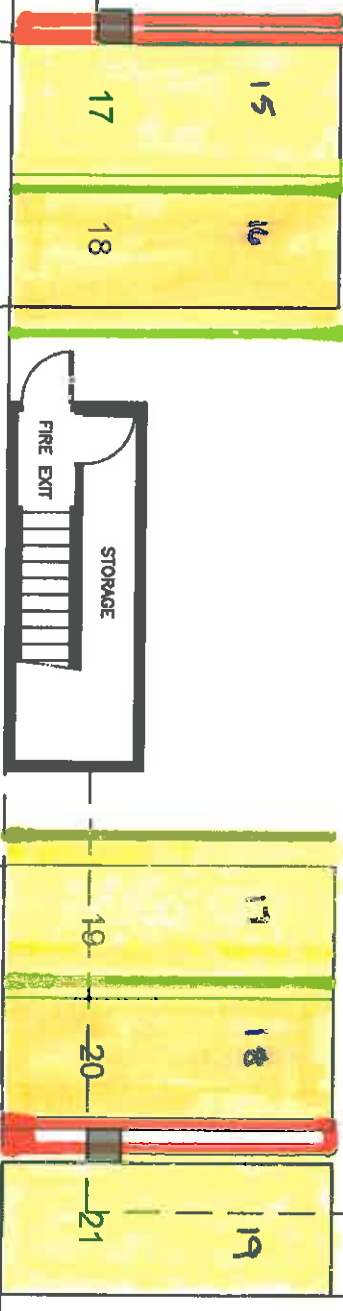

NOBLE STREET

NOBLE STREET

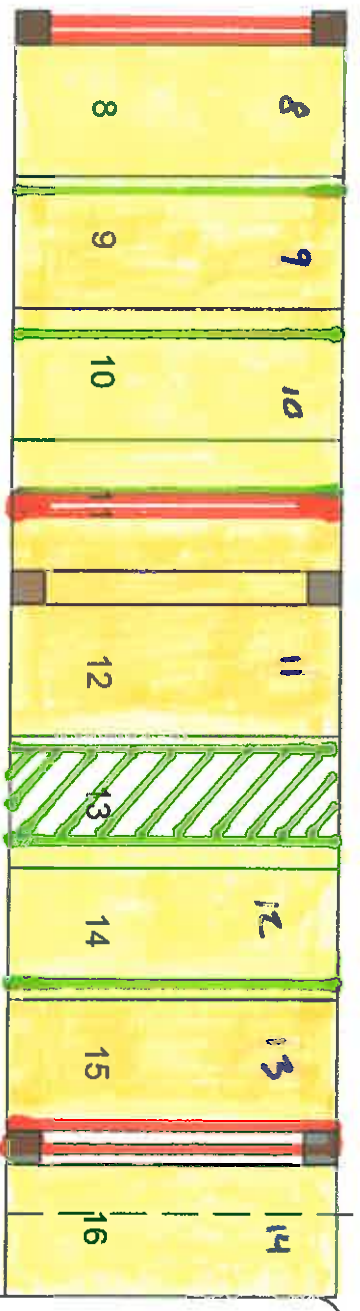
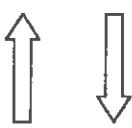
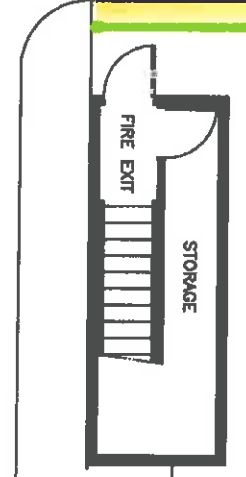
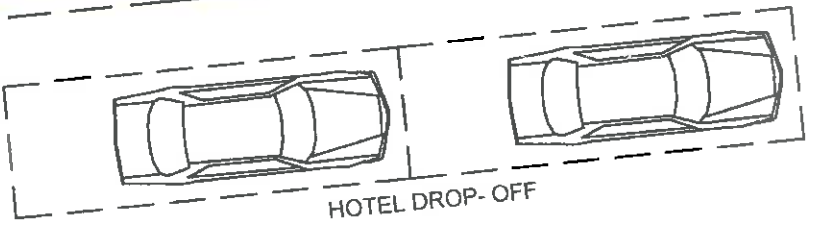

GROUND FLOOR PLAN

TOTAL BUILDING FOOT PRINT: 2,307 SQF.
 RECEPTION AND LOBBY: 964 SQF.
 BAR & RESTAURANT: 973 SQF.
 MISCELLANEOUS: 233 SQF.